

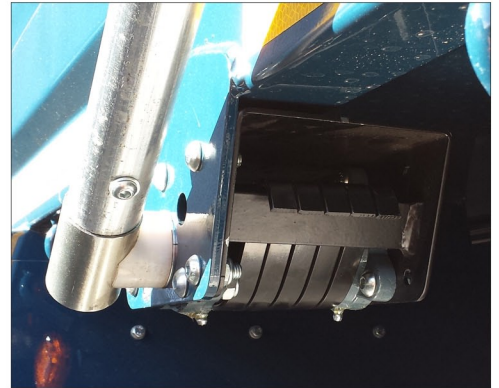

GrabCover

SHEETING SYSTEM

transcover
we've got it covered!



SAFE

Fast and efficient covering of grab-loaders from the ground or gantry.



SIMPLE

Installation takes just 10 man hours. Robust spring-driven steel arms provide force to the rear and are spooled from a motor at the front.

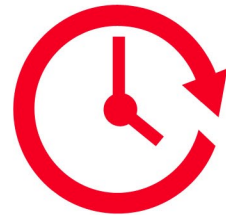

FAST

Covers in just 20 seconds!



Strong

Bent tube arms bolt together for a robust solution with no vulnerable corners / joins



Rip resistant mesh or PVC with tie down options



Proven

Over 10,000 systems installed



Warranty

See reverse for details



MANUFACTURED
BY TRANSCOVER

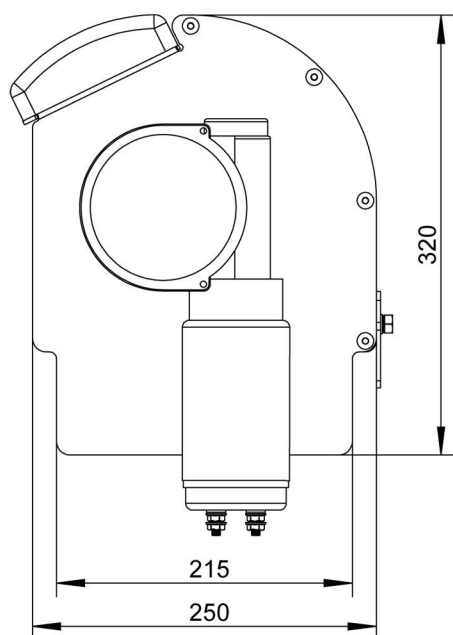

HEADBOARD EAR
OPTION

SPRING ASSEMBLY

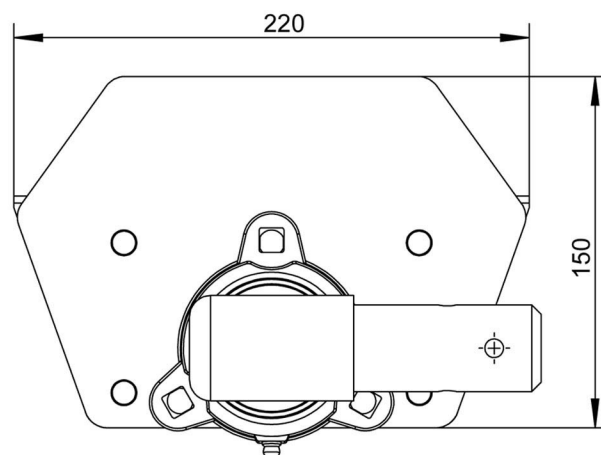
**System Specification**

24v Electric
Tubular steel arms 42mm - 48mm adjustable
Steel headboard ears with aluminium backplate

Options / Additions

12v Electric
Longer arm versions available

Containers / Body Data

Covers up to 8.5m long

Weight

90kg

Tarps

Duramesh
Supermesh
Powermesh
PVC

Warranty

1 year
Lifetime spring warranty
3 year motor warranty

